

THE MOVE, 154 LOUDOUN ROAD, ST JOHNS WOOD, NW8 0DJ



£400 PW

[£1,733 PCM] (FEES APPLY)

1 BEDROOM(S)

AVAILABLE: NOW

Offered for long term rental a 1-bedroom apartment on the 7th floor of The Move, a recently constructed block situated on the corner of Loudoun Road and Alexandra Road, benefiting from video entry phone and 24-hour CCTV surveillance. EPC: B

- Modern p/built block
- 7th floor apartment
- Approx 516 sq ft (48 sq m)
- Furnished/unfurnished
- Bright reception room
- Private balcony
- Fully fitted kitchen
- Double bedroom
- Family bathroom/WC
- Lift access; 24-hour CCTV

T: 020 7691 9000

E: info@excel-property.co.uk

W: www.excel-property.co.uk

JP: www.excel-property.london/JP

A: 146 Finchley Road, London, NW3 5HS



THE MOVE, 154 LOUDOUN ROAD, ST JOHNS WOOD, NW8 0DJ

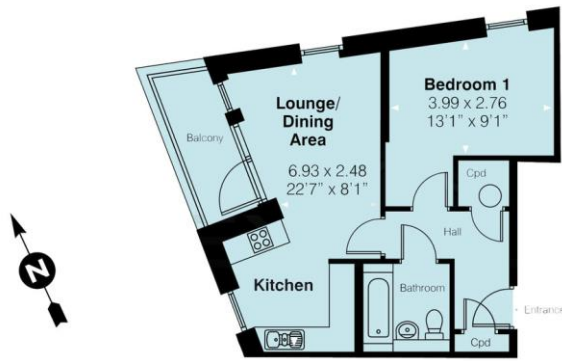

7TH FLOOR GROSS INTERNAL FLOOR AREA
516 SQ FT / 48 SQ M

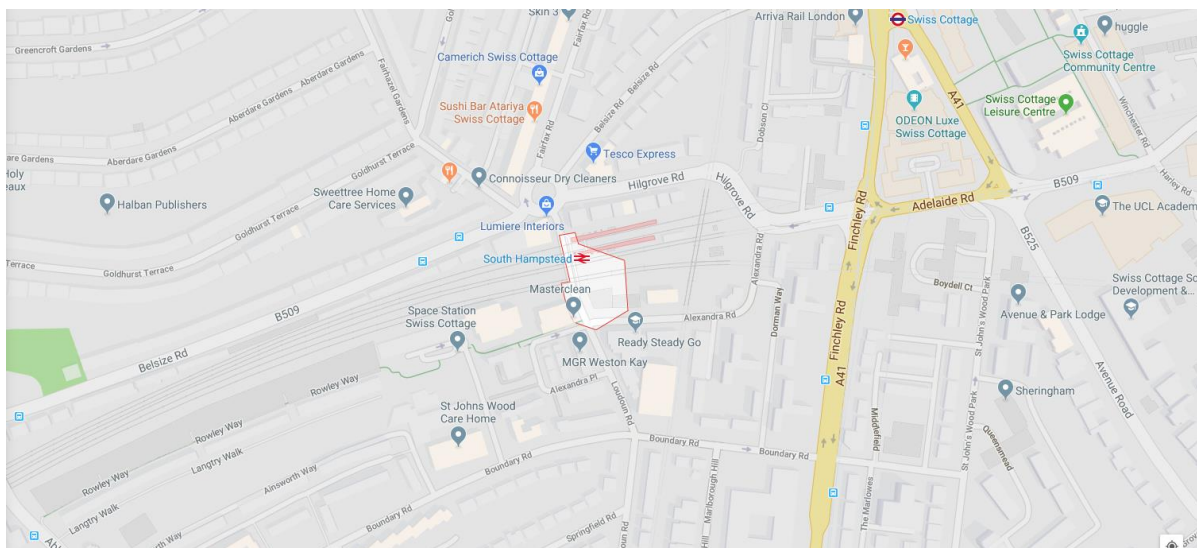

T: 020 7691 9000

E: info@excel-property.co.uk

W: www.excel-property.co.uk

JP: www.excel-property.london/JP

A: 146 Finchley Road, London, NW3 5HS

