

BOSTON PLACE, MARYLEBONE, LONDON, NW1 6ER



£400 PW

[£1,733.33 PCM] [FEES APPLY]

1 BEDROOM(S)

AVAILABLE: 26TH SEPTEMBER 2022

Available for long term rental, a well-proportioned 1 bedroom apartment, set on the first floor of a converted building in yellow stock brick, located in Boston Place, an attractive intimate character mews only minutes from Marylebone tube & rail station. EPC: D

- Attractive character mews
- Central London location
- 1st floor conversion
- Neutrally decorated
- Furnished/unfurnished
- Bright & airy reception
- Modern open-plan kitchen
- Double bedroom
- Fully tiled bathroom/WC
- Minutes from Marylebone tube & rail station

T: 020 7691 9000

E: info@excel-property.co.uk

W: www.excel-property.co.uk

JP: www.excel-property.london/JP

A: 146 Finchley Road, London, NW3 5HS



BOSTON PLACE, MARYLEBONE, LONDON, NW1 6ER

Boston Place, NW1

Approximate Gross Internal Area
378 sq ft / 35.11 sq m

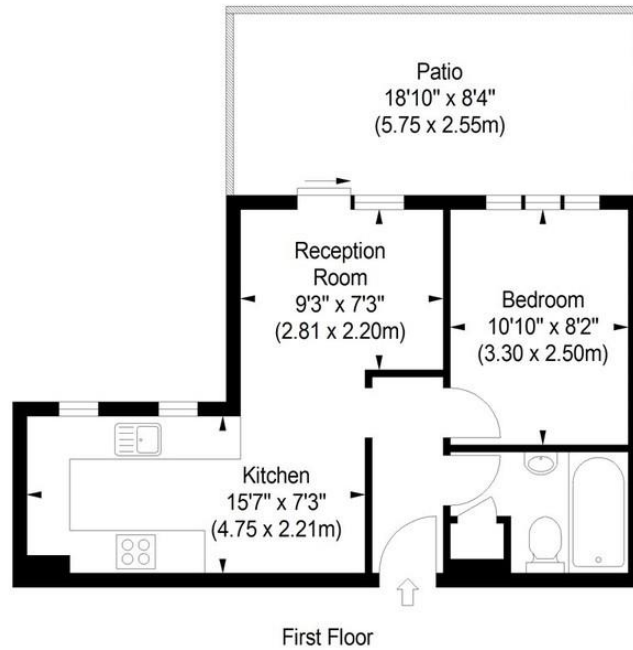

ILLUSTRATION FOR IDENTIFICATION PURPOSES ONLY

ALL MEASUREMENTS ARE MAXIMUM, AND INCLUDE WINDOW BAYS AND WARDROBES WHERE APPLICABLE
THIS PLAN MUST NOT BE REPRODUCED BY ANY OTHER PERSON WITHOUT PERMISSION

T: 020 7691 9000

E: info@excel-property.co.uk

W: www.excel-property.co.uk

JP: www.excel-property.london/JP

A: 146 Finchley Road, London, NW3 5HS

