

20 ABBEY ROAD, ST JOHNS WOOD, LONDON NW8 9BW



£620 PW

[£2,686.67 PCM]

[FEES APPLY]

2 BEDROOM(S)

AVAILABLE: AVAILABLE NOW

Available FURNISHED for long term rental, a SPACIOUS two bedroom apartment, set within the iconic development of 20 Abbey Road only metres away from the world's most famous pedestrian crossing. EPC: C

- Iconic development
- 8th floor apartment
- Recently refurbished
- Double reception room
- Modern fitted kitchen
- 2 x double bedrooms
- En-suite shower room/WC
- Family bathroom/WC
- Underground parking space
- 24-hour concierge & CCTV

T: 020 7691 9000

E: info@excel-property.co.uk

W: www.excel-property.co.uk

JP: www.excel-property.london/JP

A: 146 Finchley Road, London, NW3 5HS



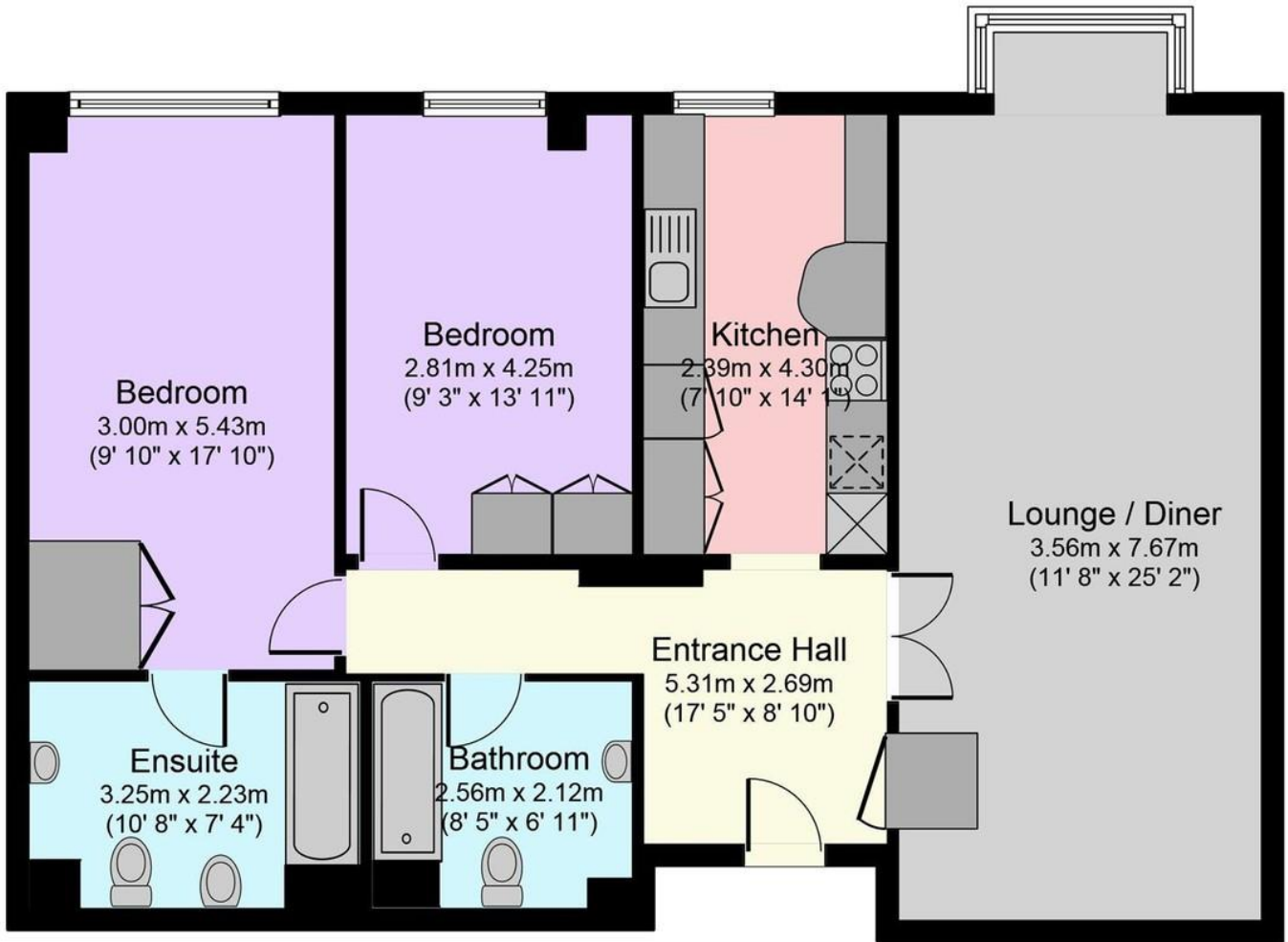

Floor Plan 1

Floor area 94.0 sq. m. (1,012 sq. ft.) approx

NOT TO SCALE For layout guidance only.

T: 020 7691 9000

E: info@excel-property.co.uk

W: www.excel-property.co.uk

JP: www.excel-property.london/JP

A: 146 Finchley Road, London, NW3 5HS

