

# FINCHLEY ROAD, ST JOHNS WOOD, LONDON, NW8 6EB



**£795 PW**

**[£3,445 PCM] (FEES APPLY)**

**3 BEDROOM(S)**

**AVAILABLE: 10TH OCTOBER 2019**

Newly refurbished apartment occupying the entire first floor of a handsome stucco fronted detached building, superbly located to take advantage of everything St Johns Wood has to offer. EPC: D

- Grand detached building
- Stucco fronted
- Occupying entire first floor
- Newly refurbished
- Furnished/unfurnished
- Reception; Dining room
- Modern fitted kitchen
- 3 x double bedrooms
- 2 x bathroom/WC's
- Mins from St Johns Wood Tube

**T:** 020 7691 9000

**E:** [info@excel-property.co.uk](mailto:info@excel-property.co.uk)

**W:** [www.excel-property.co.uk](http://www.excel-property.co.uk)

**JP:** [www.excel-property.london/JP](http://www.excel-property.london/JP)

**A:** 146 Finchley Road, London, NW3 5HS



# FINCHLEY ROAD, ST JOHNS WOOD, LONDON, NW8 6EB

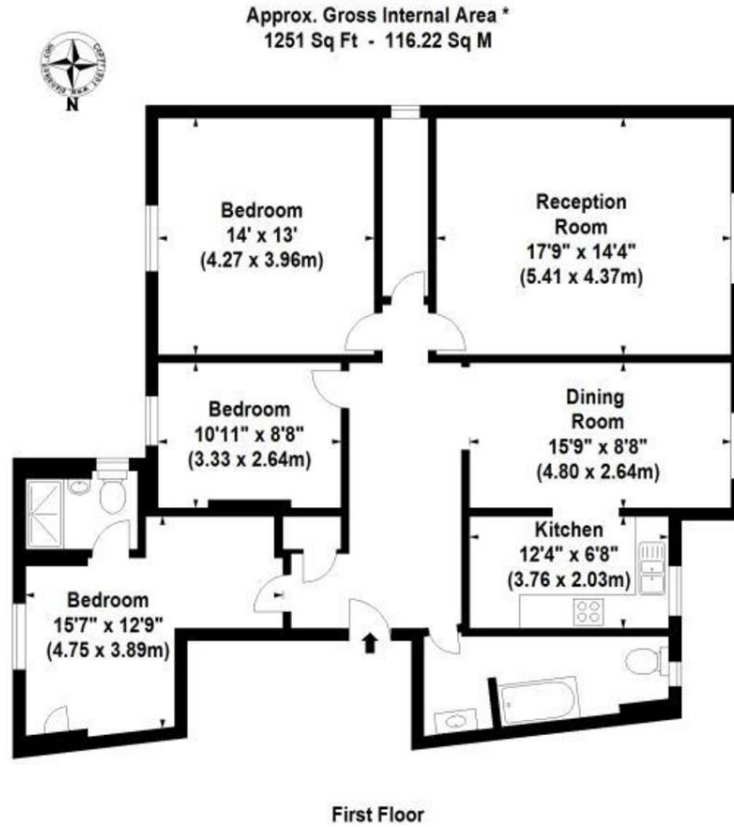
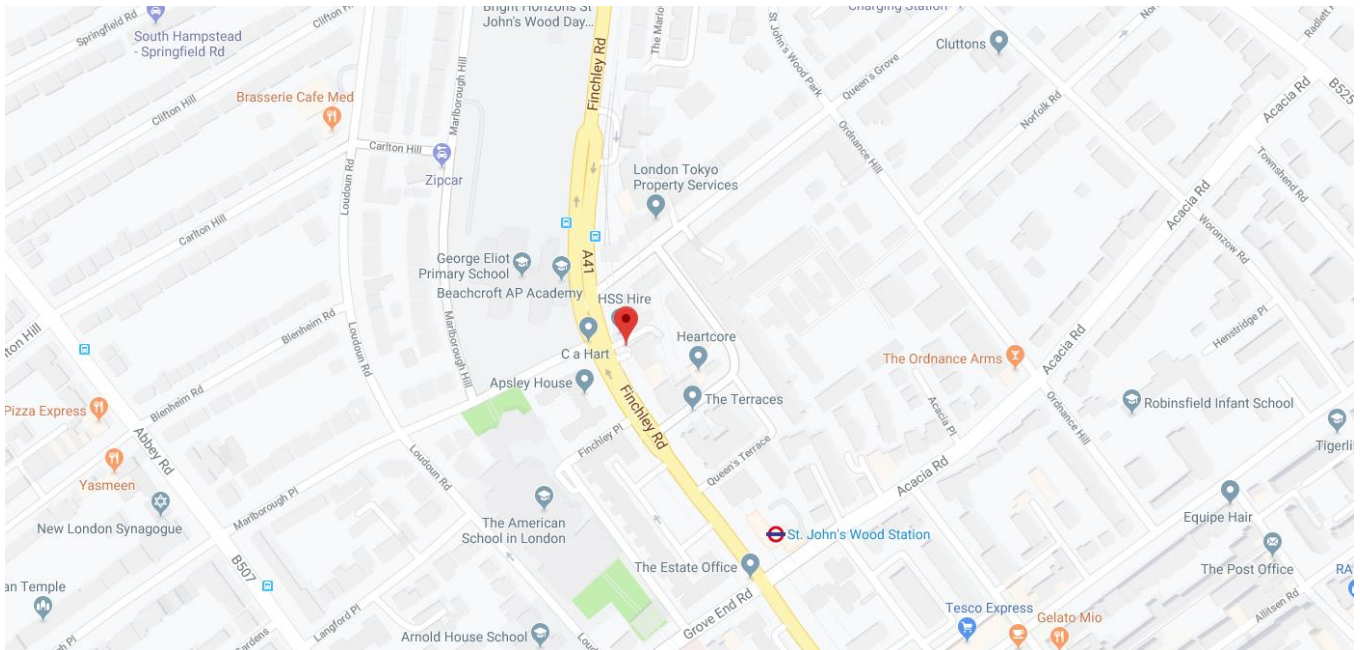

Illustration For Identification Purposes Only. Not To Scale  
\*Floor Plans Drawn According To RICS Guidelines



T: 020 7691 9000

E: [info@excel-property.co.uk](mailto:info@excel-property.co.uk)

W: [www.excel-property.co.uk](http://www.excel-property.co.uk)

JP: [www.excel-property.london/JP](http://www.excel-property.london/JP)

A: 146 Finchley Road, London, NW3 5HS

