

4B MERCHANT SQUARE EAST, HARBET ROAD, PADDINGTON, W2 1AN



£990 PW

[£4,290.00PCM]

[FEES APPLY]

3 BEDROOM(S)

AVAILABLE: NOW

Luxury London living available for rental in this stunning interior designed 3-double bedroom apartment set on the 1st floor in the Merchant Square development, superbly located within Paddington Basin adjacent to the Grand Union Canal. EPC: B

- Merchant Sq. development
- Next to Grand Union Canal
- First floor apartment
- Furnished/unfurnished
- Spacious living/dining space
- Modern open plan kitchen
- 3 x double bedrooms
- 2 x bathroom/WCs
- 24-hour concierge
- Secure underground parking

T: 020 7691 9000

E: info@excel-property.co.uk

W: www.excel-property.co.uk

JP: www.excel-property.london/JP

A: 146 Finchley Road, London, NW3 5HS



4B MERCHANT SQUARE EAST, HARBET ROAD, PADDINGTON, W2 1AN

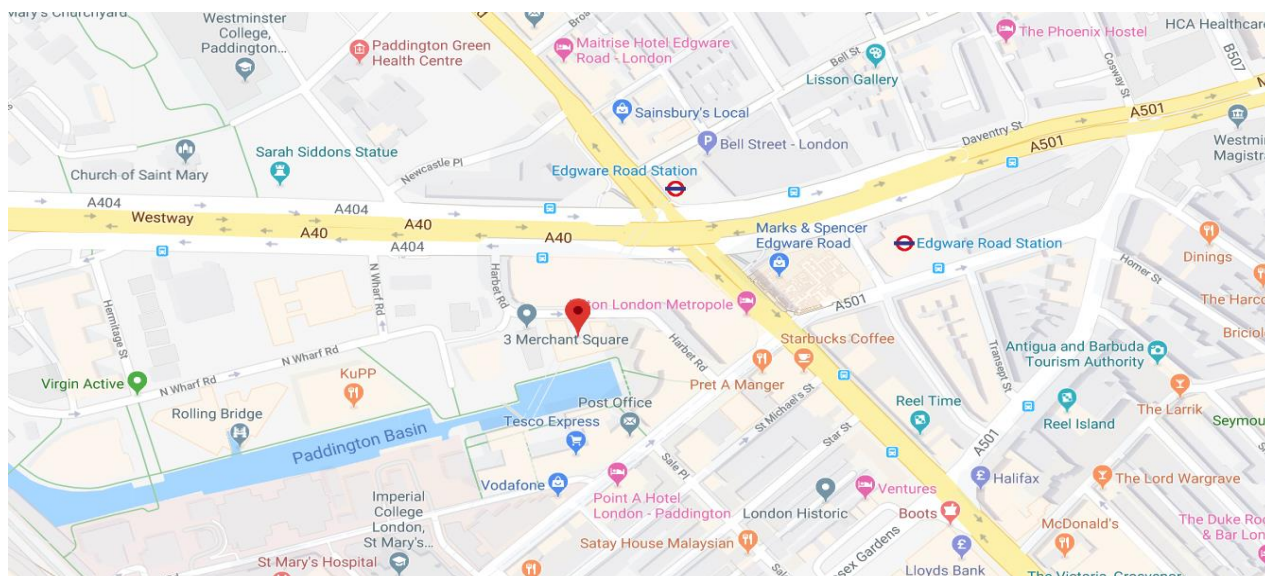
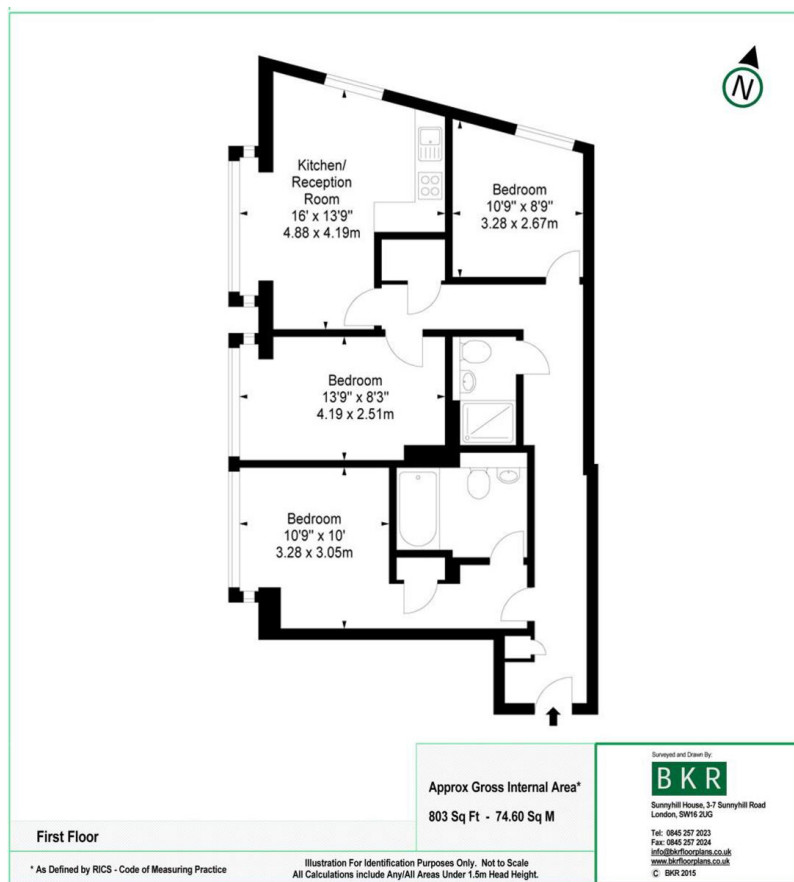

T: 020 7691 9000

E: info@excel-property.co.uk

W: www.excel-property.co.uk

JP: www.excel-property.london/JP

A: 146 Finchley Road, London, NW3 5HS

